

FOR LEASE - 1,041 SF



FEATURES:

- 1,041 SF space available for lease.
- Retail building located in the heart of St. Michael.
- High traffic counts of 23,266 VPD on HWY 241.
- Area businesses: McDonald's, Speedway, Dairy Queen, Subway, Dehmer's Meats, O'Reilly Auto Parts, Napa Auto, USPS, Dunn Brothers & more

Lease Rate
\$14.00/psf NNN
Tax - \$3.40 & Cam - \$3.60

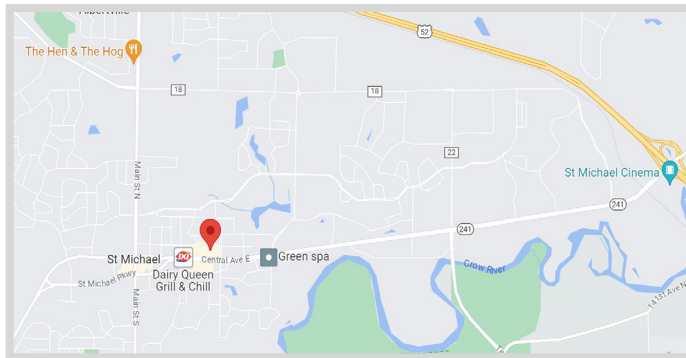

Overview 1
 Aerial Maps 2
 Site Plans 3
 Photo Gallery 4
 Demographics 5



Chad Weeks
612.619.9911
cweeks@arrowcos.com



Steve Fischer
612.619.9991
sfischer@arrowcos.com

Contact
Phone: 763.424.6355
Fax: 763.424.7980

Arrow Companies
7365 Kirkwood Court N. Suite 335
Maple Grove, MN 55369

www.arrowcos.com

AERIAL & MAP

FOR LEASE - 1,041 SF



SITE PLAN

FOR LEASE - 1,041 SF

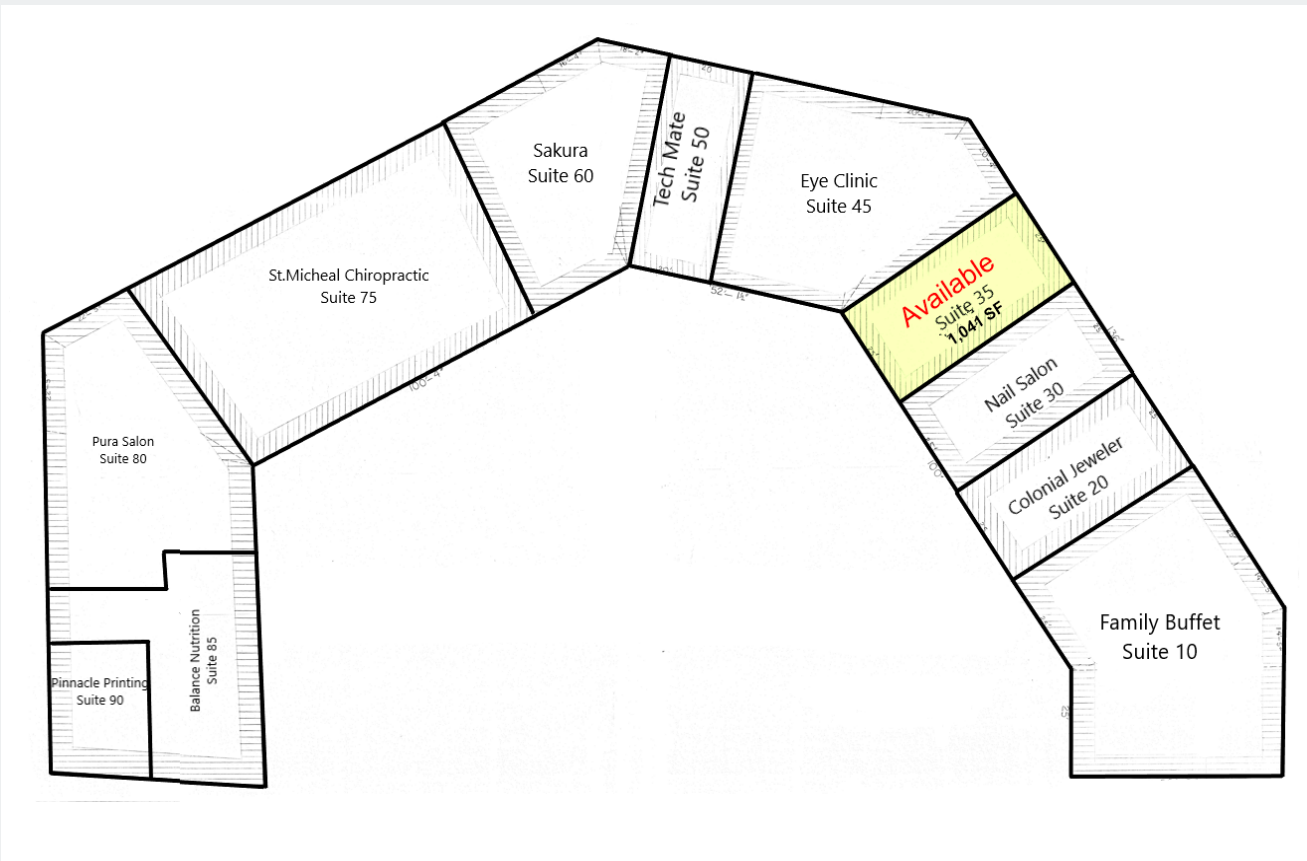

OUTSIDE GALLERY

FOR LEASE - 1,041 SF



Available Suite



Monument Sign



DEMOGRAPHICS

FOR LEASE - 1,041 SF

Demographic Summary Report

St. Michael Mall			
400 NE Central Ave E, Saint Michael, MN 55376			
Building Type: General Retail	Total Available: 0 SF		
Secondary: Restaurant	% Leased: 100%		
GLA: 21,724 SF	Rent/SF/Yr: -		
Year Built: 1988			
Radius	1 Mile	3 Mile	5 Mile
Population			
2028 Projection	6,643	29,985	50,571
2023 Estimate	6,258	28,291	47,741
2010 Census	5,083	23,229	37,589
Growth 2023 - 2028	6.15%	5.99%	5.93%
Growth 2010 - 2023	23.12%	21.79%	27.01%
2023 Population by Hispanic Origin	164	884	1,382
2023 Population	6,258	28,291	47,741
White	5,810 92.84%	25,385 89.73%	43,122 90.32%
Black	152 2.43%	1,153 4.08%	1,780 3.73%
Am. Indian & Alaskan	40 0.64%	126 0.45%	200 0.42%
Asian	119 1.90%	942 3.33%	1,485 3.11%
Hawaiian & Pacific Island	5 0.08%	16 0.06%	23 0.05%
Other	132 2.11%	669 2.36%	1,132 2.37%
U.S. Armed Forces	0	2	9
Households			
2028 Projection	2,275	10,015	17,140
2023 Estimate	2,136	9,424	16,131
2010 Census	1,690	7,589	12,379
Growth 2023 - 2028	6.51%	6.27%	6.26%
Growth 2010 - 2023	26.39%	24.18%	30.31%
Owner Occupied	1,804 84.46%	8,223 87.26%	14,212 88.10%
Renter Occupied	332 15.54%	1,201 12.74%	1,919 11.90%
2023 Households by HH Income	2,137	9,423	16,131
Income: <\$25,000	178 8.33%	472 5.01%	815 5.05%
Income: \$25,000 - \$50,000	209 9.78%	1,030 10.93%	1,438 8.91%
Income: \$50,000 - \$75,000	211 9.87%	1,103 11.71%	1,752 10.86%
Income: \$75,000 - \$100,000	343 16.05%	1,213 12.87%	2,168 13.44%
Income: \$100,000 - \$125,000	232 10.86%	1,492 15.83%	2,415 14.97%
Income: \$125,000 - \$150,000	622 29.11%	1,862 19.76%	2,908 18.03%
Income: \$150,000 - \$200,000	295 13.80%	1,584 16.81%	3,097 19.20%
Income: \$200,000+	47 2.20%	667 7.08%	1,538 9.53%
2023 Avg Household Income	\$107,864	\$120,025	\$127,550
2023 Med Household Income	\$113,739	\$114,971	\$119,590

Contact

Phone: 763.424.6355
Fax: 763.424.7980

Arrow Companies

7365 Kirkwood Court N. Suite 335
Maple Grove, MN 55369